

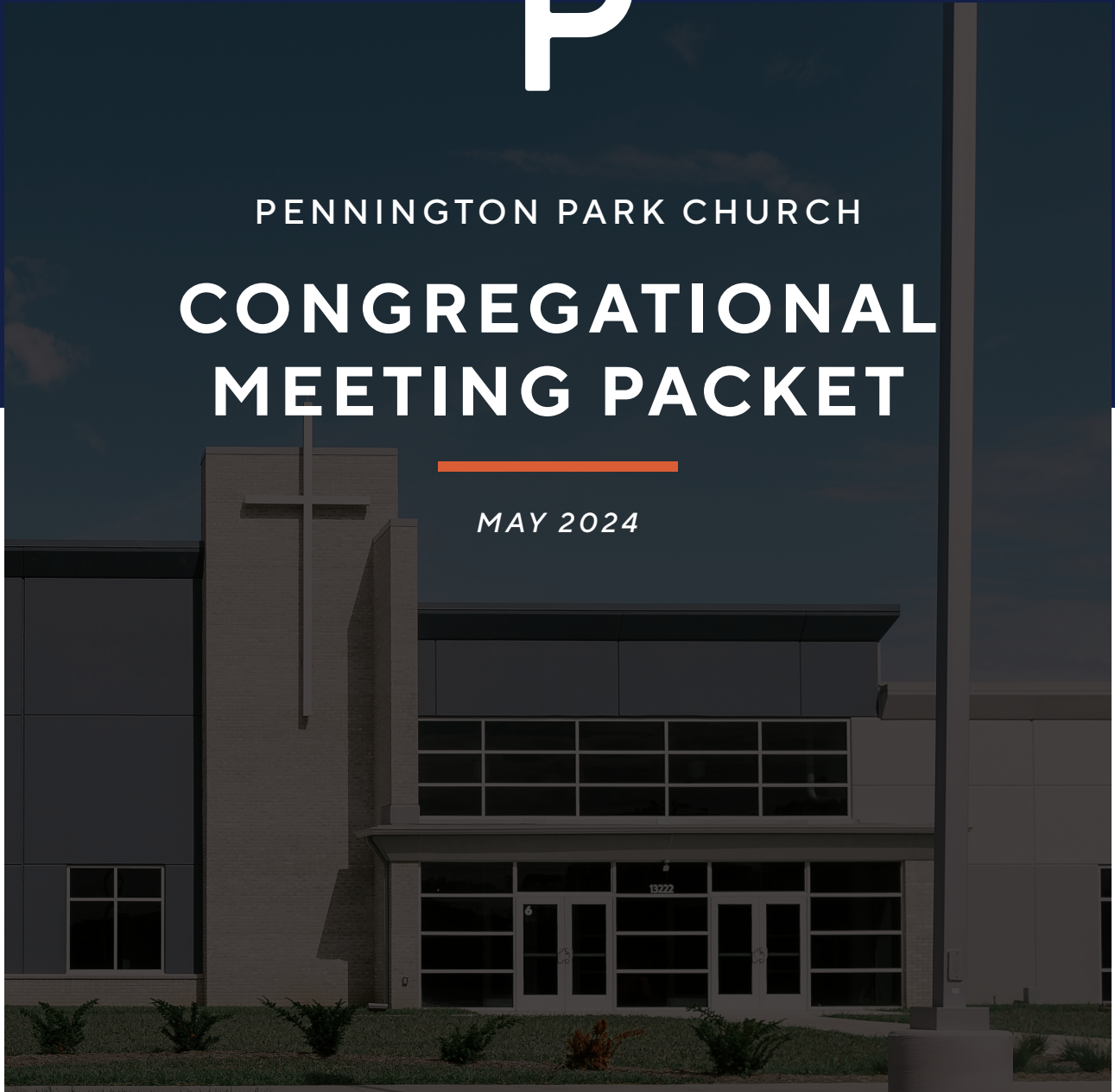

PENNINGTON PARK CHURCH

CONGREGATIONAL MEETING PACKET

MAY 2024



**Q&A
MEETING**

April 28
12:15 PM | Sanctuary

**CONGREGATIONAL
MEETING & PITCH-IN**

May 5
5:00 PM -7:00 PM | Sanctuary



TABLE OF CONTENTS

MARCH MEETING MINUTES	03
NEW MEMBER CANDIDATES	04
EXITING MEMBERS	05
NEW ELDER CANDIDATES	06
CHRIS BEALS' SABBATICAL	07
IMPACT CAMPAIGN & BUILDING EXPANSION	08
SUMMER MINISTRY OPPORTUNITIES	11

MARCH CONGREGATIONAL MEETING MINUTES

MOTION 1:

I approve the meeting minutes from the March Congregational Meeting.

MARCH MEETING MINUTES



NEW MEMBER CANDIDATES

MOTION 2:

I approve the following candidates as Covenant Members.



KATHY
NICHOLAS

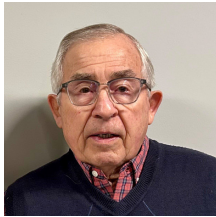

RON
NICHOLAS



JOHN
MOORE



ROSIE
MOORE



CORRIE
CASE



PERRY
CASE



CHRISTIANA
SIEGELIN



JONATHAN
SIEGELIN



LEVI
FRAZIER



HALEIGH
FRAZIER



ERIC
VON MERVELDT



BETH
VON MERVELDT



SARALIZ
GRIFFEY



BRIAN
GRIFFEY

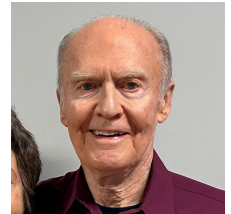

JERRY
ROTRAMEL

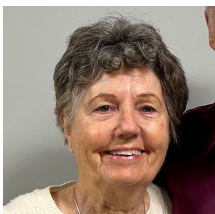

GLORIA
ROTRAMEL

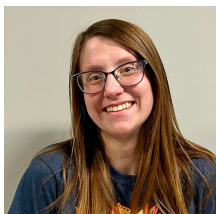

ESTHER
RAMSEY



DRU
FURBEE



ELIZABETH
FURBEE

EXITING MEMBERS

MOTION 3:

I approve the removal of the following individuals as Covenant Members.

WHO

Paula Huitsing

Dawn Sylce

Esther Phang

Wilson Phang

WHY

The following members are exiting membership at Pennington Park. The elders have engaged with each of these members as they exit and have worked to shepherd them out of membership just as they work to shepherd new members into membership. Please pray that the Lord would lead them to another gospel preaching church where they can continue to grow and use their gifts for God's glory and to edify those around them.

NEW ELDER CANDIDATES

MOTION 4:

I approve Kent Hatcher as an elder.



KENT HATCHER NEW ELDER CANDIDATE

Kent and his family have been part of the Pennington Park Church since 2018. During this time, he has actively been involved in various church activities, serving in the Children's Ministry, as well as taking roles in ushering, greeting, and leading a small group. Kent has been blessed with 30 years of marriage to his amazing wife, Angela, and they are proud parents to two awesome daughters; Becca, who is currently in med school at Marian University, and Ally, who attends Cedarville University. Professionally, Kent works in Public School Finance. In his free time, Kent can be found enthusiastically cheering on Purdue. Boiler up!

MOTION 5:

I approve Paul Martin as an elder and his title change from "Director" to "Pastor" of Compassion and Care Ministry.



PAUL MARTIN NEW ELDER CANDIDATE

Paul and his wife Beth have been attending PPC for over three years. They are actively involved on the hospitality team and are also a part of a small group that where they have hosted and led the group on different occasions. Paul has been serving in pastoral ministry alongside his wife Beth for over 50 years, and they have served congregations in New Jersey, Pennsylvania, Kokomo, Indiana, and Galveston, Indiana. Paul and Beth have two children - their son Geoffrey and his wife Anna, who have a 10-month-old son named Magness, and their daughter Courtney and her husband Austin, who have two children named Hadley (11) and Bodie (8). In his leisure time, Paul enjoys working out at the Fisher's YMCA, reading and doing devotionals, doing yard work, detailing vehicles, attending events with his grandchildren, and traveling with his family.

CHRIS BEALS' SABBATICAL

CHRIS BEALS' SABBATICAL 2024

The elders have had a sabbatical policy in place for several years. With Chris beginning his tenth year at PPC, the elders have approved a 12-week sabbatical to be taken this summer (May 6th – July 28th). We've witnessed many benefits a sabbatical serves from observing College Park Church and other churches. There are no issues predicating this sabbatical as the intent is to proactively rejuvenate rather than address burnout or other issues. Due to the unique weight that comes with leadership in church ministry, an intentional 12-weeks to unplug and "sit at the feet of Jesus" will be an invaluable investment into Chris, his family, and our church. Below is a description of the summer preaching plan in Chris' absence. For questions, please contact [Dave Cooper](#), chairman of the elders at Dave.Cooper@ey.com.

The Beals Family Sabbatical Prayer Requests:

Deep spiritual refreshment focused on being with the Lord rather than doing ministry for the Lord

Slow, unhurried, and robust time in the Word and in prayer

Quality time connecting with my family

Instill the discipline of being present with my family and not distracted physically, mentally, or emotionally

SUMMER PREACHING SERIES

"Kingdom Come" will be a 10-week series this summer which spans across all four New Testament Gospels. We'll consider the unique perspectives of Jesus that each Gospel writer presents, the good news of the kingdom which Jesus reveals in his ministry, and what it looks like to live as faithful servants of the King today as we await his return. Join us as this journey through the Gospels begins on Sunday, May 12!

IMPACT CAMPAIGN

IMPACT CAMPAIGN UPDATE

It is with immense gratitude and joy to share the latest update on our Impact Campaign. Through the sacrificial generosity and support of you, our congregation, we are thrilled to announce we have an incredible **\$4,788,197** in commitments and designated gifts!

But just as encouraging is the fact that **82%** of our members have committed to this Impact Campaign. This encouraging level of involvement truly demonstrates our shared commitment to the vision and mission of our church. We are deeply thankful to God for His gracious work and for moving in our hearts to give sacrificially. Every dollar contributed represents not just a financial gift, but a tangible expression of commitment to God's work in and through this ministry.

As we continue on this journey together, let us remember that our ultimate goal is not just to meet a financial target or build a building, but to make a lasting gospel impact in the lives of individuals and families in our surrounding community and to the ends of the earth. Together, and by God's grace, we are making a difference as we seek to live out the Great Commission.

Thank you once again to each and every one of you who has prayed, committed, contributed, and supported the Impact Campaign and our vision. Your faithfulness and generosity are deeply encouraging. May God continue to bless, lead, and work in a way in which He receives all the glory.

"Now to Him who is able to do far more abundantly than all that we ask or think, according to the power at work within us, to Him be glory in the church and in Christ Jesus throughout all generations, forever and ever. Amen." (Ephesians 3:19-20)

IMPACT CAMPAIGN

MOTION 6:

Per the recommendation from the elders, I approve proceeding forward with construction for the expansion project in accordance with the Impact Campaign and utilize short term financing.

SHORT-TERM FINANCING

The short-term financing would help bridge the gap between the timing of when construction payments are due and the collection of pledges made from the congregation. The terms of the arrangement would include a two-year interest only period whereby the payment owed would equate to the interest charged on the outstanding amount borrowed. At the end of the two-year period, principal and interest would be due over an established amortization period. The intent would be to fully pay off the short-term financing by the end of year three as the pledges are collected. This arrangement allows us to begin the project sooner to ensure the costs of the project are contained.

NEXT STEPS

If the motion passes and short term financing is secured, then construction for the expansion project would begin this summer and would take approximately 9-12 months to complete. Construction and renovation to our current space will have an impact on our ministries. A plan will be communicated once this is solidified in coming months.

BUDGETED COST AND FUNDING

\$5.3M

BUILDING COST

Anticipated total building expansion cost: **\$5,300,000**

\$4.75M

FUNDS RAISED

The \$4.75M will be paid using the three year commitments from PPC families.

\$550K

CASH

\$550,000 will be paid using cash from our PPC Reserves.

BUILDING EXPANSION PROJECT

THE EXPANSION PLAN

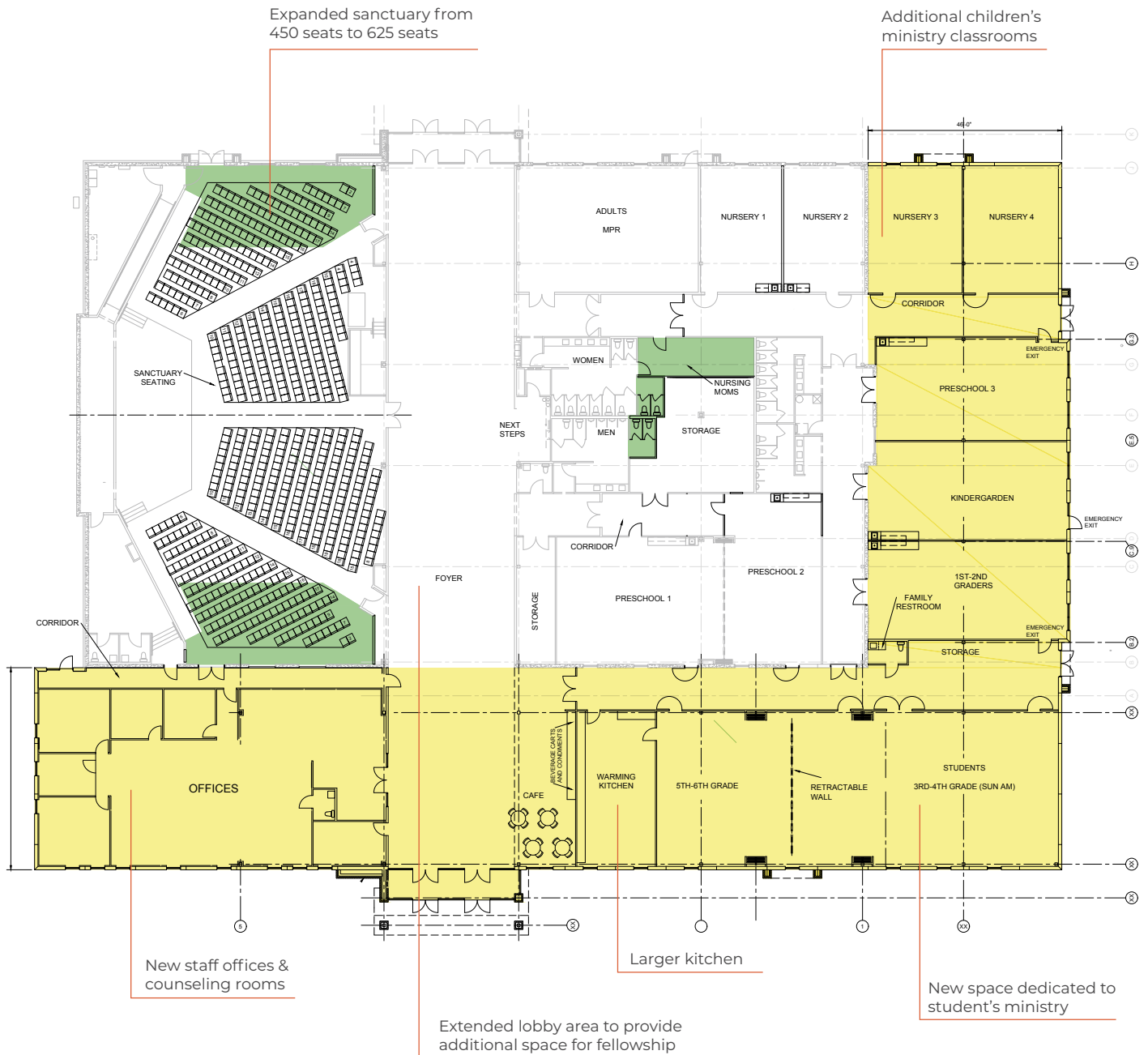

SUMMER MINISTRY OPPORTUNITIES

BACKYARD BIBLE CLUBS

Our 2024 Backyard Bible Clubs will officially begin during the first week of June. We have six different clubs running throughout the entire month of June. These clubs are designed for preschool and elementary-aged children and take place in backyards in and around our church community. Each club will run for four days (Monday to Thursday), approximately 1.5 hours each day. Every club includes games, music, and teaching that shares the truth of God's Word and the good news of the Gospel. If you would like to volunteer at a club or register your child visit www.penningtonpark.com/bybc or contact [Matt Wheeler](mailto:mwheeler@penningtonpark.com) at mwheeler@penningtonpark.com.

CHILDREN'S MINISTRY SUMMER VOLUNTEERS

Are you passionate about making a gospel impact in the lives of children and find joy in engaging with and caring for young hearts? Consider joining our Children's Ministry team this summer! As summer approaches, we are giving our regular volunteers, leaders, and teachers a well-deserved break for rest and rejuvenation. This opens an exciting opportunity for members of our congregation who do not regularly serve in Children's Ministry (or other serving teams) to step in and invest in the lives of our children from June 2 to August 4. Whether experienced in volunteering or new to children's ministry, there is a place for everyone to thrive and contribute. We are asking for a commitment of at least 2 Sundays over the course of 10 weeks. Joining our team of dedicated volunteers could be a rewarding way to make a significant impact in the lives of our youngest generation this summer. Email [Matt Wheeler](mailto:mwheeler@penningtonpark.com) at mwheeler@penningtonpark.com to learn more!

STUDENTS MINISTRY

VOLUNTEER LEADER

Volunteer Leaders are the backbone of what we do in Students ministry! Each volunteer is assigned to help lead a grade and gender specific small group, who they'll disciple for as long as they serve in Students ministry. Our volunteers are called to know, lead, feed, and protect their flock of students, all while building community together and having a blast! If you're looking for a place where you get to see real life change happen while plugging into a deep leader community, Students is your place! Contact [Sam Drew](mailto:sdrew@penningtonpark.com) (sdrew@penningtonpark.com) for more info.

SUMMER MINISTRY OPPORTUNITIES

STUDENTS MINISTRY

BAND LEADER

The Student Band is a brand-new space to serve! We are passionate about creating a vibrant worship environment within our ministry, and need leaders who want to help disciple and develop students in their musical gifts. This is your chance to help us create a Students Worship program from the ground up! Contact [Sam Drew](mailto:sdrew@penningtonpark.com) (sdrew@penningtonpark.com) for more info.

THE BRIDGE

SMALL GROUP LEADER

Our Bridge Leaders are the heartbeat behind what we do in the Bridge! 5th and 6th grade is often such a confusing, shaping time for our students and their faith. Bridge Leaders walk alongside a specific grade and gender small group to help them grow in their faith, community, and passion for Jesus. If you're looking for a place to invest deeply in the next generation, we'd love to have you join our Bridge team! Contact [Maggie Chadwick](mailto:mchadwick@penningtonpark.com) (mchadwick@penningtonpark.com) for more information.

LARGE GROUP TEACHER

Our Large Group Teachers set the tone for the learning environment in The Bridge. Using our curriculum specifically written for a 5th and 6th grade level, Large Group Teachers craft engaging 20-minute lessons, shaped by the gospel, to teach these kids Biblical truths and help them apply it to their own walks with Jesus. If you're looking for a place to use your gift of teaching to impact the next generation, we'd love to have you join our Bridge team! Contact [Maggie Chadwick](mailto:mchadwick@penningtonpark.com) (mchadwick@penningtonpark.com) for more information.